

# FUJI 60

314GA02H11

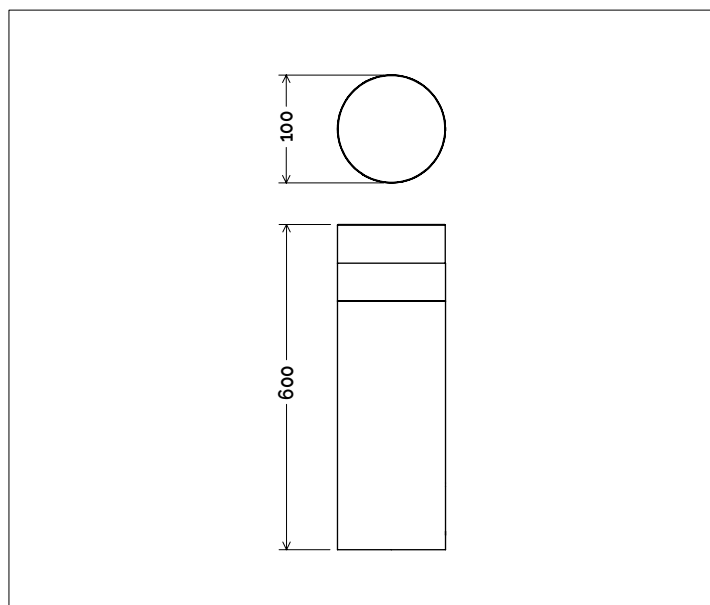

## Descrizione del prodotto / Product description

Paletto luminoso LED da esterno con ottica radiale 360° o unidirezionale 180°.

Corpo lampada e tappo superiore in alluminio verniciato. Lente realizzata da monoblocco in PMMA trasparente e dissipatore.

Disponibile con ghiera di fissaggio.

Fornito con sistema di connessione IP68 (vedi istruzioni di montaggio).

Bollard LED for outdoor with radial 360° or mono-directional 180° optic.

Body and upper cap made of painted aluminium.

Lens made of turned clear PMMA.

Available with fixing ring.

Supplied with IP68 connector (see assembly instructions)

## Dati tecnici | Technical Info

\* su richiesta / on requests

### Finiture | Finishes

- **4003** Grafite | Graphite
- **4004** Cemento | Concrete
- **4006** Corten Scuro | Dark Corten
- **4008** Verde Scuro | Dark Green
- **4015** Bianco Fiorentino | Flore. White
- **4024** Rosso Bolgheri | Bolgheri Red
- Verniciati RAL | RAL Paintings\*

Potenza   Power	10W
Corrente   Current	-
Tensione   Voltage	220/240Vac
Tolleranza cromatica   Chromatic tolerance	3 SDCM
Flusso luminoso   Luminous Flux	1150lm
Mantenimento del flusso luminoso   Flux Maintenance	≥50.000h
Temperature di esercizio   Operating temperature	-20° ~ 45°

## Simbologia tecnica Technical informations

	Conforme alle direttive CE
	Conforme alle normative RoHS
	Classe II
<b>IP65</b>	Indice di Protezione IP65
	Connettore stagno in dotazione

## Temperatura di Colore Color Temperature

<b>9027</b> - 2700K CRI 92
<b>9030</b> - 3000K CRI 92
<b>9040</b> - 4000K CRI 92

## Ottiche Optics

	<b>R1</b> - 360°
	<b>R2</b> - 180°

## Sistemi di Controllo Control System

	<b>On / Off</b> (a board / on board)
<b>PUSH</b>	<b>Push *</b> (remoto escluso / remote excluded)
<b>1-10V</b>	<b>1-10V, 0-10V *</b> (remoto escluso / remote excluded)
	<b>DALI *</b> (remoto escluso / remote excluded)

## Creazione Codice | Code construction

314GA02H11-XXXX-XX-XXXX

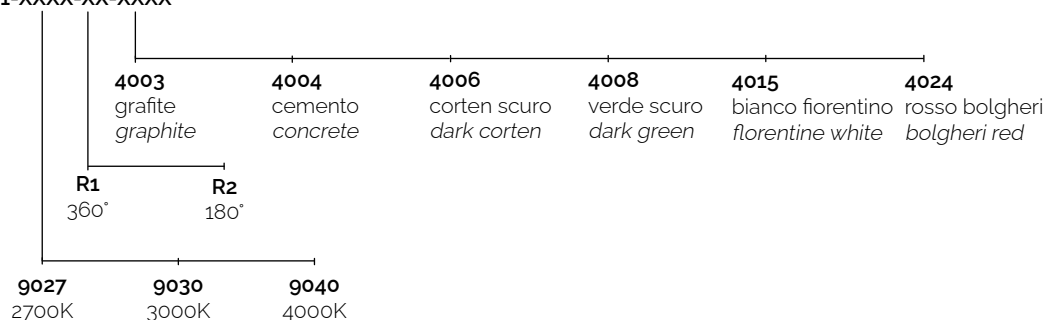

## Dati Fotometrici | Photometric Specification

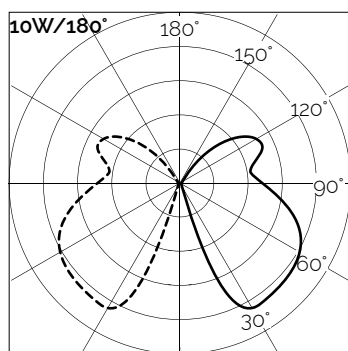

R (m)	180°	E (lx)
0.10		1350
0.20		447
0.50		109
1.00		37
1.50		21

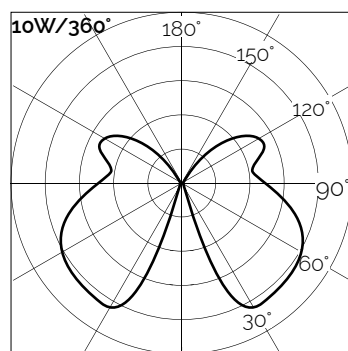

R (m)	360°	E (lx)
0.10		1350
0.20		447
0.50		109
1.00		37
1.50		21

## Accessori | Accessories

gB003

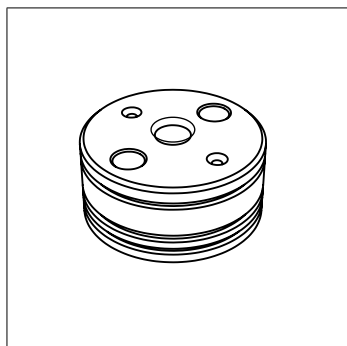

Base per fissaggio a terra  
(Ø96mm H.45mm)

Ground Fixing Basic  
(Ø96mm H.45mm)

gB002

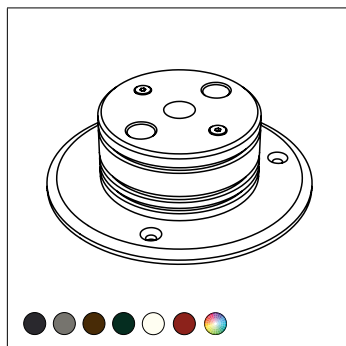

Ghiera per fissaggio a terra  
(Ø160mm H.6mm)

Ground Fixing Ring  
(Ø160mm H.6mm)